

STYLE 2

Ref : A-Type galvanised

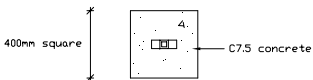

SECTION B-B

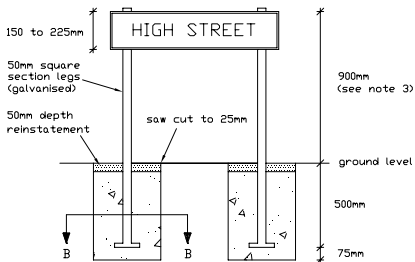
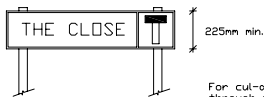

For cul-de-sacs and no through roads, 'T' to diagram 816.1 to be added.

STREET NAMEPLATE SPECIFICATION

1. Street nameplates to be erected on both sides of each road
2. Street nameplates to be manufactured from 115g SIC half hard (99% pure) aluminium.
3. Text to be die pressed black lettering in 90mm Kindersley with a 12.5mm black bead on a white background.

NOTES:

1. Reinstatement material C30 concrete to be used in concrete / flag surfacing. Cold lay bitmac in bituminous materials.
2. On Engineers instruction only, if nameplate is to be shortened, lugs on base are to be refixed.
3. Installation height may vary due to local conditions, seek advice where necessary.

TENDRING DISTRICT COUNCIL
TOWN HALL
CLAFTON-ON-SEA
ESSEX
CO15 1SE

T.MacKinlay M.Sc.,F.C.I.H.,D.M.S.,M.C.I.E.H.
HEAD OF TECHNICAL
& PROCUREMENT SERVICES

Client: TENDRING DISTRICT COUNCIL

Job Title:
STREET NAMEPLATE SPECIFICATION

Drawing Title:
TYPICAL DETAILS

Scale: 1:20 Drawn By: JDS

Date: October 2000 Checked By:

Project No:

Drawing No:
E/H/4431

Revision: